

DASH NO.	M CODE	MADE FROM
----------	--------	-----------

SD

2025-76-9

REVISIONS

ISSUE	CHANGES
0	ER 36507 ME 08/09/95
1	CN 36727 A KH 12/21/95
2	CN 38060 C HVN 08/10/00

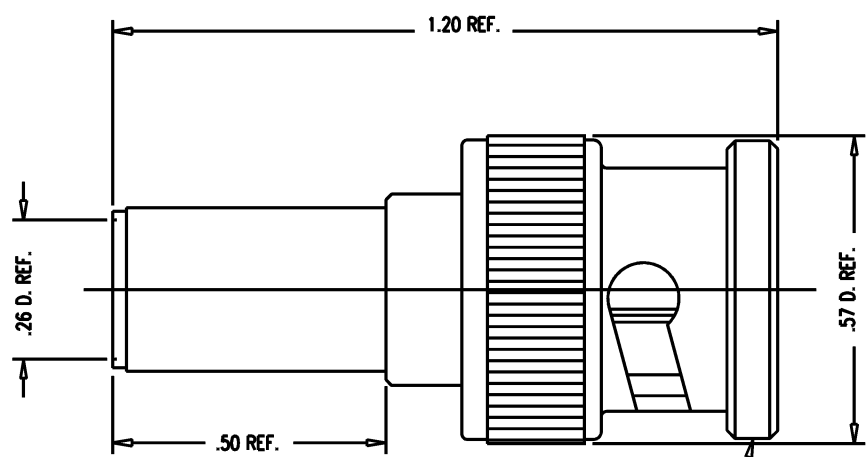

STAMP: KINGS 2025-76-9

- NOTES:
- FOR USE WITH TYPE 734 CABLE.
  - FOR CRIMPING USE DIE KTH-2186.
  - FOR CABLING INSTRUCTIONS SEE 3-683 (BULK PACKAGING) OR 3-681 (BAG PACKAGING).
  - CENTER CONTACT AND SLEEVE TO BE SUPPLIED UNASSEMBLED.
  - MARK PACKAGE: KINGS 2025-76-9  
XX XX (DATE CODE)
  - INTERFACE PER MIL-STD-348, FIG. 301-1 (AS APPLICABLE).
  - MATERIAL:
    - INSULATOR: TEFLON
    - GASKET: SILICONE RUBBER
    - K-GRIP SLEEVE: COM'L BRONZE
    - SPRING WASHER } BERYLLIUM COPPER
    - OUTER CONTACT }
    - ALL OTHER METAL PARTS: BRASS
  - FINISHES:
    - CENTER CONTACT: HARD GOLD PLATE
    - SPRING WASHER: SILVER PLATE
    - ALL OTHER METAL PARTS: NICKEL PLATE
  - ELECTRICAL CHARACTERISTICS:
    - NOMINAL IMPEDANCE: 75 ~W
    - FREQUENCY RANGE: DC TO 2 GHz
    - WORKING VOLTAGE: 500 VOLTS RMS

QGS0743

SCALE 4:1

APPROX SURFACE AREA

USED ON

REF:

PLUG, 75~W BNC, M

DRAWN	ME	08/09/95
-------	----	----------

DESIGN	VLS	DATE 08/09/95
--------	-----	---------------

APPR.	VLS	DATE 08/17/95
-------	-----	---------------

**KINGS**  
ELECTRONICS CO., INC.  
TUCKAHOE, NEW YORK 10707

2025-76-9

SD