

Connectors for Copper Conductor

Two Hole Lugs - 90° Standard Barrel 600V to 35KV Applications

Material: High Conductivity Wrought Copper
Finish: Electro Tin Plate



Cat. No.	Wire Size		Bolt Size	Dimensions (in.)						Die Code	Die Color
	Code	Flex		B	C	D	E	F	G		
256-31426-141*			#10	1.25	.37	.07	.20	7/32	5/8	N/A	N/A
256-31426-6SPH	#14-10 AWG		#10	1.30	.37	.07	.20	7/32	5/8-3/4	N/A	N/A
256-31426-6			#10	1.30	.37	.07	.20	7/32	5/8	N/A	N/A
256-31426-6S			#10	1.30	.37	.07	.20	7/32	5/8-3/4	N/A	N/A
256-30695-1409			#10	1.19	.41	.06	.26	7/32	5/8-3/4	21	RED
256-31426-144*	#8 AWG	23 Navy, #8 Weld	#10	1.25	.42	.08	.26	1/4	5/8	21	RED
256-31426-33UB		37/24 = 14.9 kcmil	#10	1.19	.41	.06	.26	7/32	5/8-3/4	21	RED
256-31426-33UBPH			#10	1.19	.41	.06	.26	7/32	5/8-3/4	21	RED
256-30695-1411				#10	1.19	.44	.08	.30	7/32	5/8-3/4	24
256-30695-1183B	#6 AWG	30 Navy	#10	1.19	.44	.08	.30	7/32	5/8-3/4	24	BLUE
256-30695-1356		#6 Weld	#10	1.19	.43	.08	.30	7/32	5/8	24	BLUE
256-30695-1014B		61/24 = 24.6 kcmil	1/4	1.50	.44	.08	.30	1/4	1	24	BLUE
54205UB		133/.014	1/4	1.28	.44	.08	.30	1/4	1/2	24	BLUE
256-30695-252UB			1/4	1.56	.43	.08	.30	1/4	1	24	BLUE
54206UB		#4 AWG	40-50 Navy 91/24 = 36.7 kcmil 133/.0177, 49/.029	1/4	1.28	.52	.10	.37	1/4	5/8	29
54207UB	#2 AWG	60 Navy #4 Weld 125/24 = 50.4 kcmil	1/4	1.28	.59	.11	.41	1/4	5/8	33	BROWN
54208UB	#1 AWG	75 Navy 150/24 = 60.5 kcmil 175/24 = 70.6 kcmil, 133/.0223	1/4	1.28	.68	.11	.47	1/4	5/8	37	GREEN
54209UB	1/0 AWG	100 Navy, #1 Weld	3/8	1.93	.75	.13	.52	3/8	1	42	PINK
54209UB0412		225/24 = 90.8 kcmil, 133/.0254 225/24 = 90.8 kcmil, 133/.0254	1/4	1.55	.75	.13	.52	1/4	3/4	42	PINK
54261UB	2/0 AWG	125 Navy, 1/0 Weld	5/16	1.63	.83	.14	.57	1/32	7/8	45	BLACK
54210UB		275/24 = 111 kcmil	3/8	1.93	.83	.13	.57	3/8	1	45	BLACK
54260UB		133/.0282	1/2	2.81	.83	.14	.57	3/8	1	45	BLACK
54266UB	3/0 AWG	150 Navy, 2/0 Weld	5/16	1.75	.94	.14	.63	1/32	1	50	ORANGE
54211UB		325/24 = 131 kcmil	3/8	1.81	.94	.14	.63	3/8	1	50	ORANGE
54265UB		133/.0316, 259/.0227, 427/.0177	1/2	2.81	.94	.14	.63	1/2	1 1/4	50	ORANGE
54212UB	4/0 AWG	200 Navy, 3/0 Weld	3/8	1.93	1.03	.14	.70	3/8	1	54	PURPLE
54270UB		450/24 = 182 kcmil, 703/.0154	1/2	3.00	1.03	.14	.70	1/2	1 3/4	54	PURPLE
54213UB	250 kcmil	250 Navy	3/8	1.93	1.13	.14	.77	3/8	1	62	YELLOW
54275UB			1/2	2.81	1.13	.18	.77	1/2	1 3/4	62	YELLOW
256-30695-399UB		4/0 Weld, 550/24 = 222 kcmil	3/8	2.80	1.25	.15	.79	3/8	1	62	YELLOW
58265UB		133/.0399, 259/.0286, 637/.018	1/2	2.81	.94	.14	.79	1/2	1 3/4	62	YELLOW

Tooling: Pg. 79-100

Die Selector Chart: Pg. 105-109

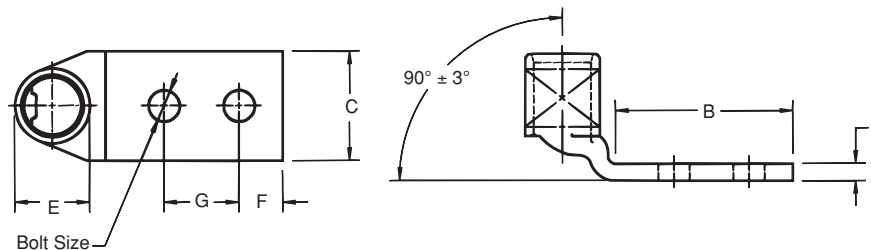

Color-Keyed®

Connectors for Copper Conductor

Two Hole Lugs - 90° Standard Barrel 600V to 35KV Applications (continued)

Material: High Conductivity Wrought Copper
Finish: Electro Tin Plate



Cat. No.	Wire Size		Bolt Size	Dimensions (in.)						Die Code	Die Color
	Code	Flex		B	C	D	E	F	G		
54214UB	300 kcmil	300 Navy	3/8	1.93	1.25	.15	.85	3/8	1	66	WHITE
54280UB			1/2	3.00	1.25	.15	.85	1/2	1 1/4	66	WHITE
54215UB	350 kcmil	350 Navy	3/8	1.93	1.36	.18	.93	3/8	1	71	RED
54282UB			1/2	3.00	1.36	.18	.93	1/2	1 1/4	71	RED
54216UB	400 kcmil		3/8	1.93	1.41	.17	.96	3/8	1	76	BLUE
54283UB			3/8	1.93	1.41	.17	.96	3/8	1 1/16	76	BLUE
58277UB		400 Weld, 925/24 = 373 kcmil 259/.0393, 427/.0306	1/2	3.00	1.61	.22	1.04	1/2	1 3/4	80	N/A
54218UB	500 kcmil	500 Navy	3/8	1.93	1.61	.22	1.10	3/8	1	87	BROWN
54286UB			1/2	3.00	1.61	.22	1.10	1/2	1 3/4	87	BROWN
256-30695-1221B			3/8	1.61	.22	1.10	3/8	1	87	BROWN	
54220UB	600 kcmil	1100/24 = 444 kcmil	3/8	1.93	1.75	.24	1.20	3/8	1	94	GREEN
54289UB			1/2	3.00	1.75	.24	1.20	1/2	1 3/4	94	GREEN
54291UB	700 kcmil	1325/24 = 535 kcmil	1/2	3.00	1.84	.23	1.25	1/2	1 3/4	99	PINK
58281UB			1/2	3.00	1.80	.28	1.25	1/2	1 3/4	99	PINK
54223UB	750 kcmil		1/2	3.00	1.94	.27	1.33	1/2	1 3/4	106	BLACK
54224UB	800 kcmil		1/2	3.00	2.01	.27	1.38	1/2	1 3/4	106	BLACK
54226UB	900 kcmil	1925/24 = 777 kcmil	1/2	3.00	2.18	.31	1.50	1/2	1 3/4	115	YELLOW
54228UB	1000 kcmil	1000 Navy	1/2	3.00	2.27	.30	1.55	1/2	1 3/4	125	N/A

Tooling: Pg. 79-100

Die Selector Chart: Pg. 105-109

